

Pillsbury Hall & Staughton Hall

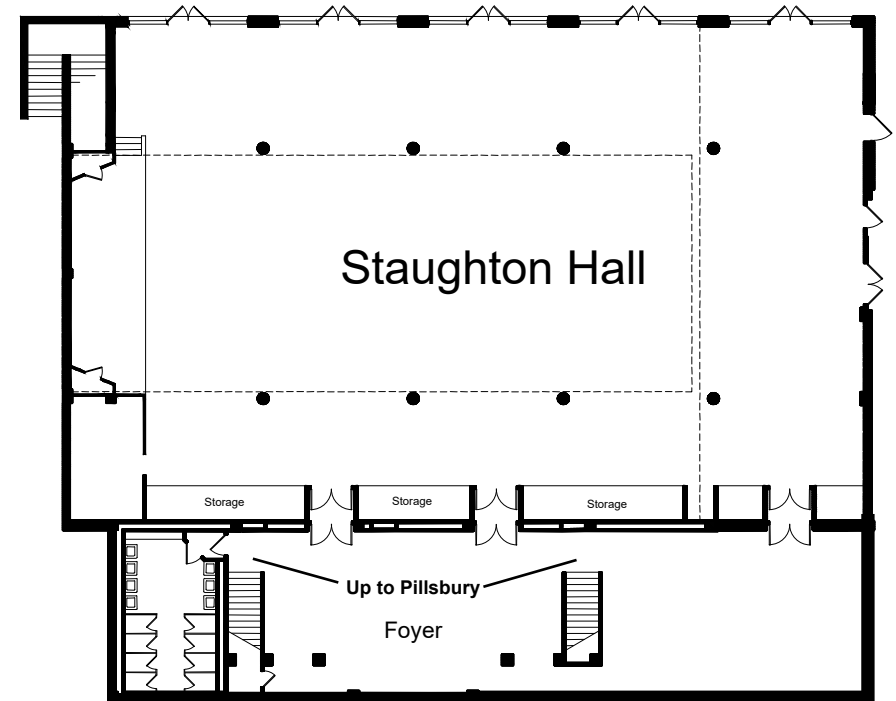
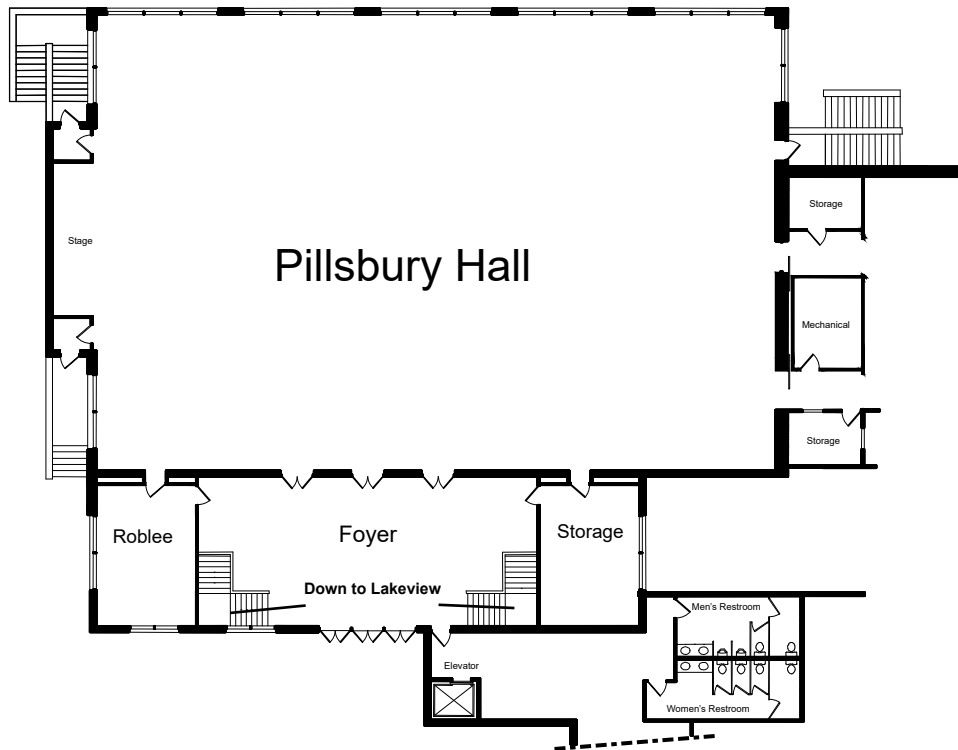

Pillsbury Hall and Staughton Hall Meeting Rooms

Pillsbury Square Footage including pre-event space: 8,946

Lakeview Square Footage including pre-event space: 8,946

Total Square Footage including pre-event space: 18,229

Name; L' x W' Room can be divided**	Square footage	Ceiling Height	Theater	Seminar	Rounds	Class room	Circle	Hollow Square
Pillsbury Hall 109' x 73'	7,957	14'	900	600	400	160	100	96
Pillsbury Hall Foyer 43' x 23'	989	11.6'						
Staughton Hall 109' x 73'	7,957	10.8'	500	270	180	72	45	45
Staughton Hall Foyer 43' x 23'	989	11'						
Roblee 23' x 15'	345	10.8'	25	16	16	12	20	14

Meeting Room Setup Chart

Green Lake Conference Center • www.glcc.org • guestservices@glcc.org • 920-294-3323

Meeting Room Setup Chart

Green Lake Conference Center • www.glcc.org • guestservices@glcc.org • 920-294-3323

Meeting Room Setup Chart

Green Lake Conference Center • www.glcc.org • guestservices@glcc.org • 920-294-3323

Meeting Room Setups

Seminar

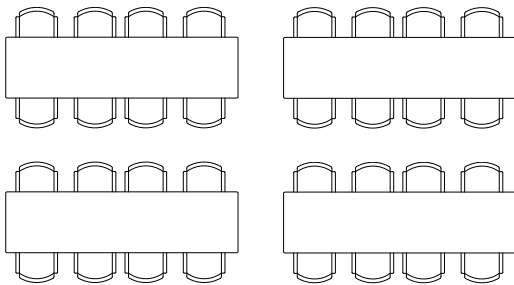

Rounds

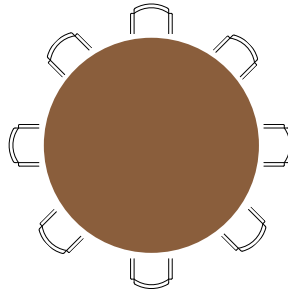

Theater

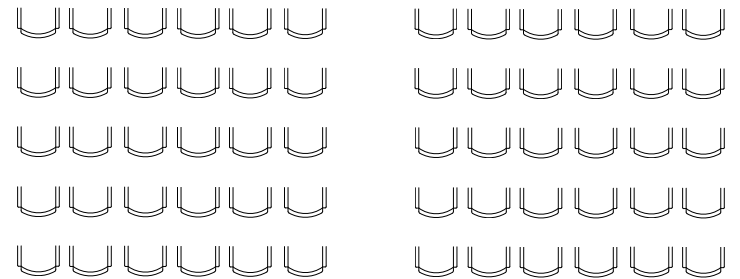

Hollow Square

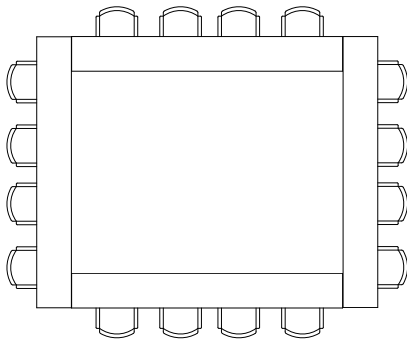

Crescent With Round Table

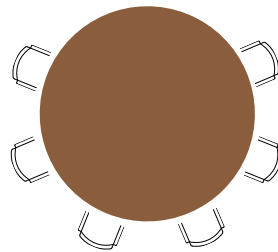

Circle

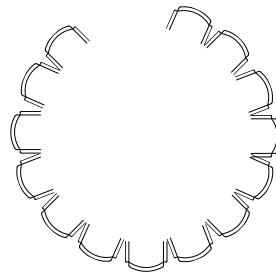

Classroom

